

Montpellier

THE PERFECT BALANCE OF FUNCTION AND STYLE

LAUNDRY - DISHWASHING - COOKING - COOLING

Installation and Operating Instructions



Fully Integrated Dishwasher MDI700

Please read these instructions carefully before attempting to install or use this appliance.
We recommend that you keep these instructions in a safe place for future reference.

Welcome

Thank you for choosing this Montpellier Integrated Dishwasher.

Our Integrated Dishwashers have been designed to provide you with the best combination of style, reliability and performance to give you years of trouble-free use.

You may be familiar with a similar product, but please take time to read these instructions carefully before installing or using your Integrated Dishwasher to ensure you get the most from your purchase.

We recommend that you keep this manual in a safe place for future reference.

**2
YEAR
GUARANTEE**

— PARTS & LABOUR —

ACROSS ALL OUR MODELS

Montpellier

www.montpellier-appliances.com

Your Integrated Dishwasher is covered by a comprehensive two year Parts & Labour Guarantee. In the unlikely event that you experience a problem with your Integrated Dishwasher, you can rest assured that you are fully protected against the cost of repairs for the first 24 months. Please note that any claim must be accompanied by the model reference number, serial number and proof of purchase.

To activate your guarantee, you will need your product serial number. This can be found on the rear of the machine.

There are two ways to register your Guarantee:

- **Online:** Visit the Support page on our website and complete the online Product Registration form. www.montpellier-appliances.com
- **By Post:** Simply detach and fill in the form provided, attach a stamp and send it in the post. Don't forget to include your e-mail address so that we can send confirmation through to you.



Note: We are unable to take registrations over the phone.

Description of the Appliance

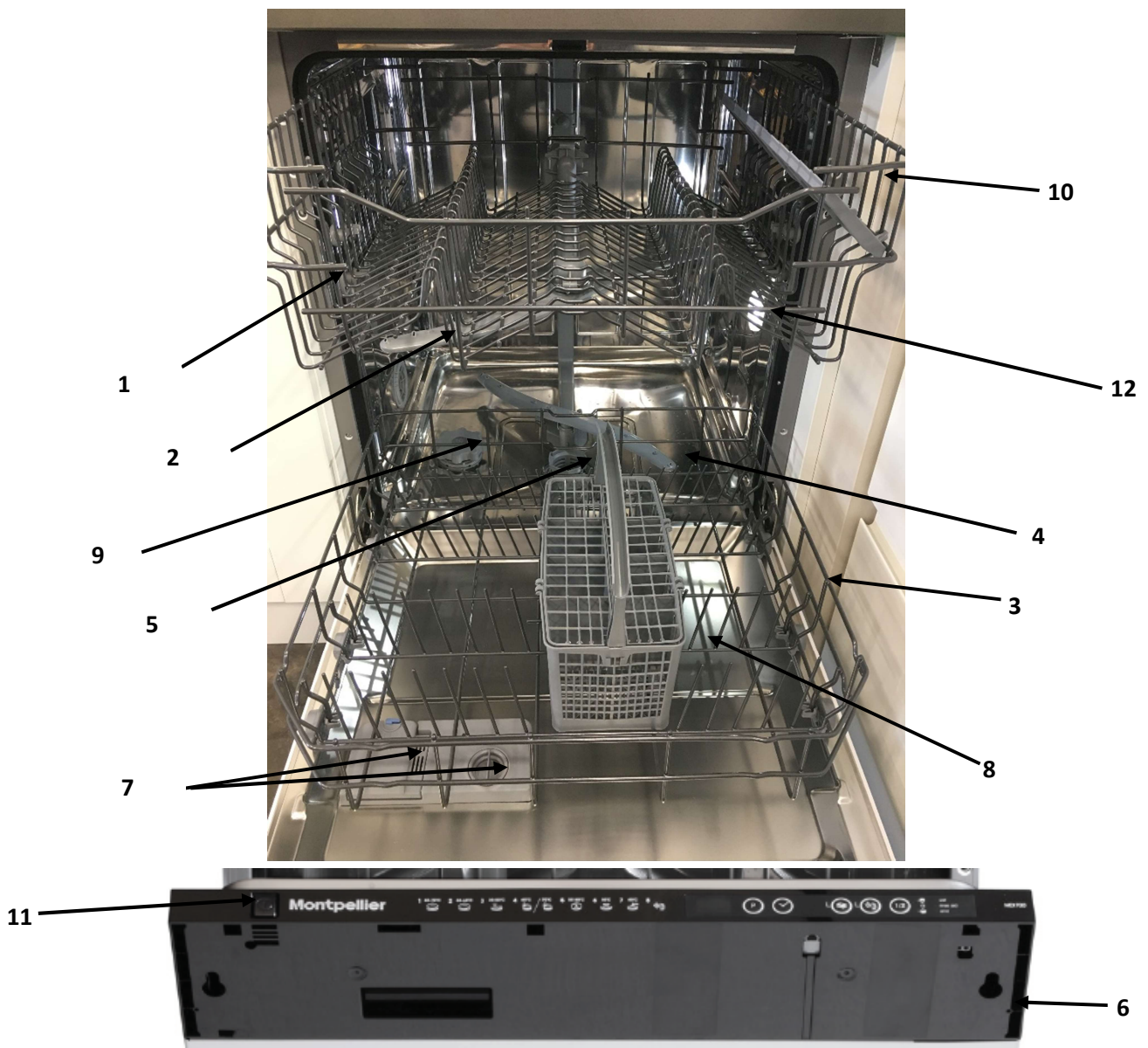

1. Upper Baskets with Racks
2. Upper Spray Arm
3. Lower Basket
4. Lower Spray Arm
5. Filters
6. Rating Plate – On Left Side of Door
7. Detergent & Rinse Aid Dispenser
8. Cutlery Basket
9. Salt Dispenser
10. Upper Basket Track Latch
11. Control Panel
12. Interior Light

CONTENTS:

Section 1. Installation

Section 2. Safety Advice

Section 3. Operating the Appliance

Section 4. Maintenance

Section 1. Installation

- Position the appliance in a dry, well ventilated room with a solid level floor. The room temperature must not fall below +5° or rise above +35°.
- This appliance is fitted with adjustable feet so that you can ensure it is sitting level. Adjust the feet by turning left or right until the appliance is level.
- The adjustable feet must never be removed.
- Plug the 3pin moulded plug into a nearby 13amp plug socket. Always make sure that you can easily gain access to switch the power on or off at the plug socket.
- **N.B. This appliance must be earthed!**
- If you have installed this appliance underneath a work surface the plug socket should have a fused switch located above the work surface so that you can easily switch the appliance on or off.
- You are advised to turn the power off at the plug socket when you have finished using your appliance.
- Before using the appliance for the first time, you must set the water softener, add salt, add rinse aid and add detergent.
- Your plumber will connect the water hose (supplied) to the water inlet connection at the rear of the appliance and to an adjacent cold water supply. It is your responsibility to ensure that the supplied washers have been used and that both connections are water tight.
- Ensure water pressure is within the range specified on the Rating Label. Your plumber will connect the water drain pipe to an adjacent sink (see Pic.1 below)
- Ensure that the water hose and water drain pipe are not kinked when the appliance is pushed into place. If either of these pipes is kinked the appliance will not operate correctly.
- Ensure that the appliance is not standing on the power cable or hoses.
- Do not use the water inlet hose of your old machine. Use the new water inlet hose and connect the hose directly to the water inlet tap. The pressure supplied by the tap should be a minimum of 0.03 Mpa and at a maximum of 1 Mpa. If the water pressure is above 1 Mpa, a pressure relief valve should be fitted.

After the connections are made, the tap should be turned on fully and checked that it is water tight. You should always turn off the water inlet tap after a wash programme is finished.

Note: An Aquastop water hose is used in some models. In such circumstances, heavy tension will exist. Do not cut the Aquastop water hose and do not let it get folded or twisted.

Water Outlet Hose

The water drain hose can be connected either directly to the water drain hole or to the sink outlet spigot using a special bent pipe (if available). The hose connection should be at a minimum of 50cm and at a maximum of 110 cm from the floor.

Please note that a drain hose longer than 4m must not be used as it may prevent the appliance from washing correctly.

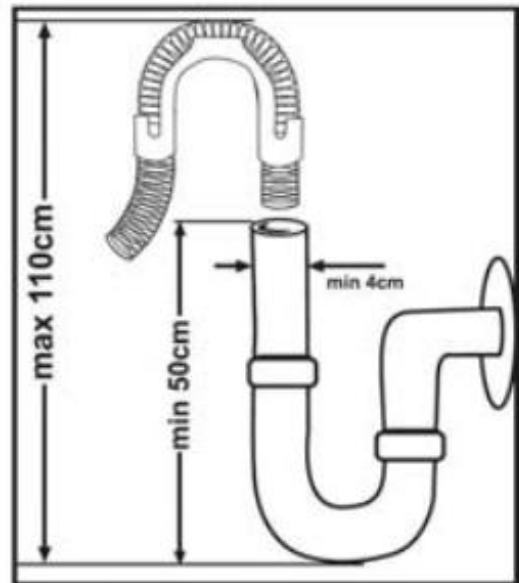
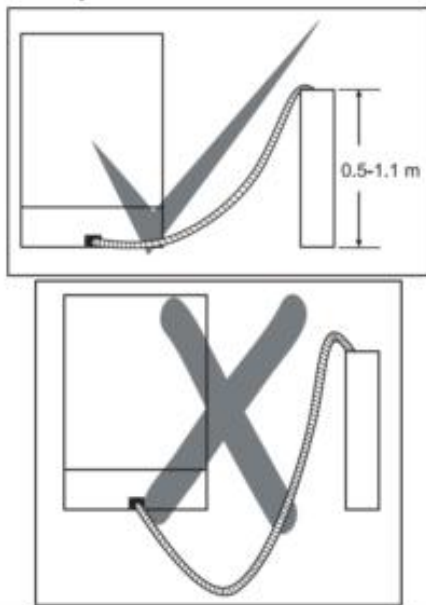

Section 2. Safety Advice

- This appliance is manufactured and intended for DOMESTIC use only. Any guarantee offered with the appliance is not valid for any installation in a commercial environment.
- **This appliance MUST BE EARTHED!**
- Never try and disconnect the power by pulling the supply cable – hold the plug firmly and pull it out of the socket.
- Never touch the plug or power cable with wet hands.
- Check the power cable periodically for signs of damage and ensure that it is not trapped underneath the appliance. If the cable is damaged, turn off the power at the socket and arrange for a qualified electrician to replace the cable.
- Never remove the power cable, open the appliance cabinet or try to modify the appliance in any way. All service work must be carried out by a qualified electrician.
- The appliance is not intended for use by persons (including children) with reduced physical, sensory or mental capabilities, or lack of experience and knowledge, unless they have been given supervision or instruction concerning the use of the appliance by a person responsible for their safety. Children should be supervised to ensure that they do not play with the appliance.
- Ensure that the appliance is sited well away from other heat sources, i.e.. open fires, boilers etc and in a dry, well ventilated room. The temperature must not fall below +5° or rise above +35°.
- Do not sit on the appliance or stand on the open door – the appliance could tip forwards.
- Keep children away from detergent and rinse aid, keep children away from the open door of the dishwasher, there could still be some detergent left inside. This appliance is not a toy – ensure that children are supervised at all times whilst in the vicinity of this appliance.
- Take care when loading the baskets with knives and cutlery. Always ensure that sharp points are pointing away from you or down into the basket.
- Only wash crockery and utensils that are clearly marked 'dishwasher safe'. Do not wash plastic items unless they are clearly marked 'dishwasher safe'. Only use dishwasher detergents and rinse aid clearly marked for use with automatic dishwashers.
- Never use non dishwasher detergent in this appliance, i.e. hand soap, washing machine detergent, washing up liquid etc.
- **Always add dishwasher salt to your dishwasher, even when using 3-in-1 tablets. This will help protect your appliance against limescale.**
- If the power supply cord is damaged, it must be replaced by the manufacturer, its service agent or similarly qualified persons in order to avoid a hazard.

Section 3. Operating the Appliance

3.1. Before Operating the Appliance

3.1.1. Adding Salt

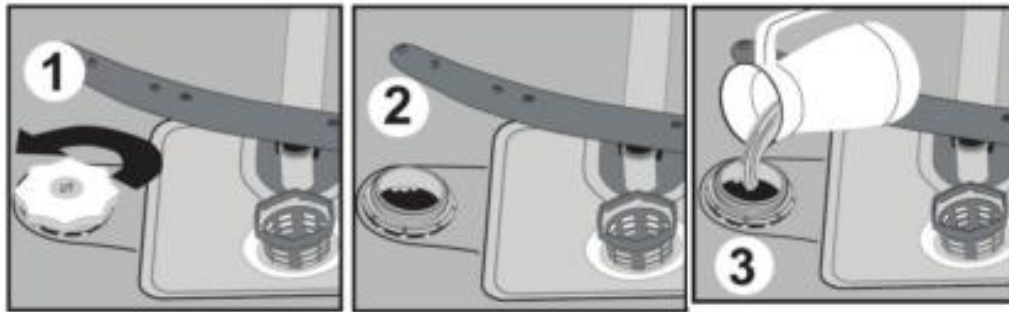

- The sole use of 3-in-1 tablets is not recommended as failure to add salt to the salt container will leave your dishwasher exposed to limescale damage which is not covered by the manufacturers guarantee. Protect your appliance by adding salt as follows:
- Remove the lower basket and then unscrew the salt container cap (1). Add water and approximately 1kg of specialist dishwasher salt to the container until almost overflowing. N.B. It is normal for a small amount of water to come out of the container whilst filling it with salt.

Note: Fill the salt compartment with water at first use only.

- Now replace the screw cap correctly and ensure that it is tight. If not, salt may leak into the dishwasher chamber which can be detrimental to the stainless steel interior. This is not covered by the manufacturers guarantee. After adding salt you should run a programme immediately to activate the water softener and flush away any salt spilled into the machine. If salt is low the indicator light will show on the control panel.

3.1.2. Adding Rinse Aid

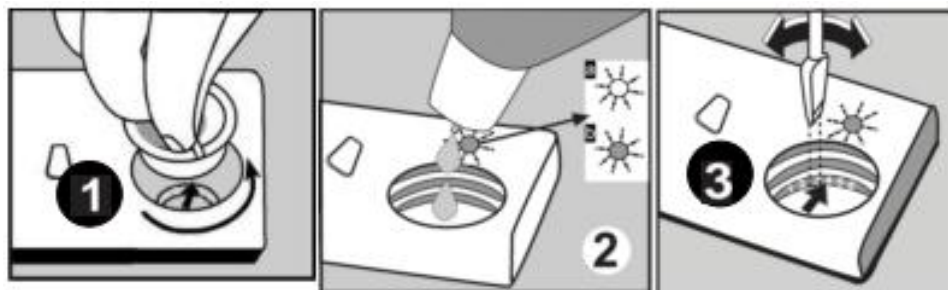

- Remove the Rinse Aid Filler Cap (1).
- Add Rinse Aid until the rinse aid level indicator becomes dark (2).
- Replace the Filler Cap (3).

If the rinse aid level is sufficient the indicator light will be dark on the control panel (2B). If more rinse aid is required the indicator will be light (2A).

3.1.3. Adding Detergent

Use specialist dishwasher detergent powder or dishwasher tablets in this appliance. However, please note that tablets do not always dissolve fully during shorter wash programmes, so you are advised to operate your appliance on a longer wash programme if using tablets.

In addition, the use of tablets may result in spots appearing on dishes and glasses.

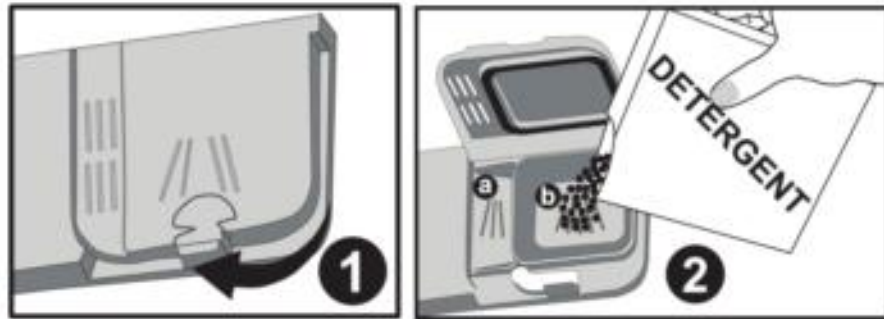

Push the latch to open the detergent container as shown in image 1. The detergent pod has level lines inside to help measure the amount of detergent you use. The pod can take a total of 40cm³ of detergent. If your dishes are heavily soiled pour 25cm³ of detergent into the larger compartment (b), if they are less soiled use only 15cm³.

If the programme selected has a pre-wash cycle you can add 5cm³ of detergent to the pre-wash compartment (a).

If using combined detergents, make sure to check the specifications on the product to ensure that it is appropriate for the wash programme, your machine, and the level of hardness of the mains water.

3.1.4. Combined Detergent – Recommended Usage

If you are using a combined detergent, add a rinse aid agent to your machine and switch the rinse agent setting to its lowest position (1) and activate the tablet detergent button in order to obtain better results. Depending on the water hardness you may need to fill the salt container with salt.

We do not recommend using 3 in 1 tablets on fast or rapid programmes as the tablet may not fully dissolve. For these programs we suggest using normal dishwasher powder.

3.1.5. Adjusting the Water Softener

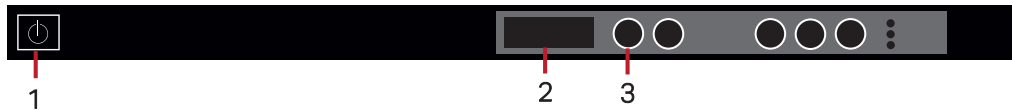

Fully-Integrated Models; INRD 13 and FNTD13

a) Press the Program selector button and keep it pressed down while your machine is not in operation,



b) Meanwhile, energise the machine by pressing the On/Off button.

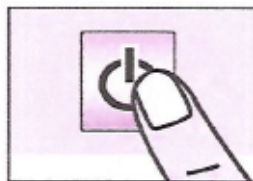

c) Keep Program selector button pressed until "P1- P2 - P3 - P4- End" lights are on and off.



d) After the "P1- P2 - P3 - P4- End" have flashed, release the Program selector button.



Your machine displays the latest entered water hardness setting.

e) You can adjust the levels by pressing Program selector button according to the table of Water Hardness Level Settings.



f) After adjusting the water hardness level, press on/off button to save settings in memory.

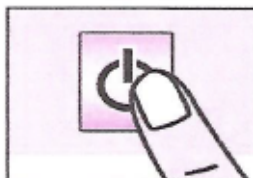

INRD 13 and FNTD13

Water Hardness Level	German Hardness dH	French Hardness dF	British Hardness dE	HARDNESS LEVEL INDICATORS
1	0-5	0-9	0-6	 <p>program</p>
2	6-11	10-20	7-14	 <p>program</p>
3	12-17	21-30	15-21	 <p>program</p>
4	18-22	31-40	22-28	 <p>program</p>
5	23-31	41-55	29-39	 <p>program</p>
6	32-50	56-90	40-63	 <p>program</p>

3.2. The Control Panel

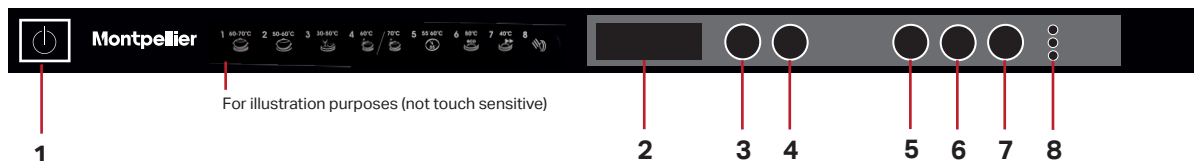

1. Power On/Off Button

2. Programme Display – Indicates programme time and time remaining.

3. Programme Selection Button – Allows you to select a suitable programme.

4. Delay Timer Button – You can delay the start of a programme by 1-19 hours by pressing this button. The delay will increase by 1 hour each time the button is pressed, once you have the desired delay press the programme selection button. If you wish to change or cancel the delay, you can adjust it with the delay timer button as it will be activated/deactivated according to the last value entered.

5. Tablet Detergent Button (3 in 1) - Press this button when you are using a combined detergent that includes salt and a rinse-aid.

6. Pre-Wash Button – Selecting this function will improve washing performance as it changes the water temperature and washing time of some programmes. Please note that if a programme is incompatible with this function, a buzzer will be activated.

7. ½ Load Button – Using this function, 3 different sorts of washing can be done: The lower basket, upper basket and both baskets.

If you have dishes in both baskets press the half load button and select the position in which both lamps are highlighted.

If you have dishes in only the upper basket, press the half load button until just the upper lamp is highlighted. No washing will be done in the lower basket.

If you have dishes only in the lower basket, press the half load button until just the lower lamp is highlighted. No washing will be done in the upper basket.

Please note: This feature may remain active following your wash, if you wish to deactivate it for your newly selected programme press the selected feature button again and check that the indicator lamp goes out.

8. Salt Warning Indicator – When your machine needs salt the salt warning indicator will come on. When this happens, add more salt.

Rinse Aid Warning Indicator – When there is insufficient rinse aid in your machine the rinse aid warning indicator will come on. When this happens, fill the rinse aid chamber.

End of Programme Indicator – When a programme has ended the end of programme indicator will come on. Additionally your machine will sound a buzzer 5 times.



3.3. Loading the Baskets

3.3.1. Upper Basket

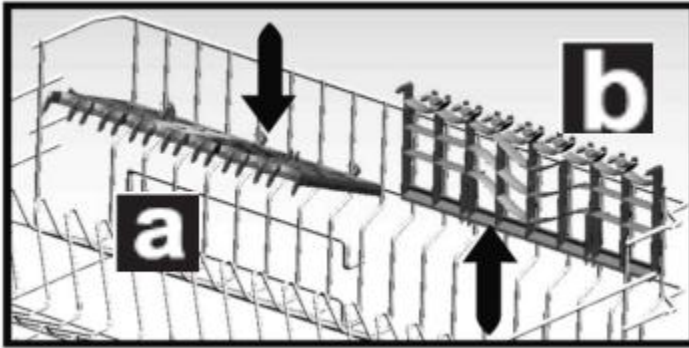

There are dish racks on the upper basket of your machine.

You can use these dish racks in an open or closed position depending on whether you want to place cups, long glasses, or cutlery on them

Ensure that items are not blocking the rotation of the top spray arm.

Upper Basket Height Adjustment

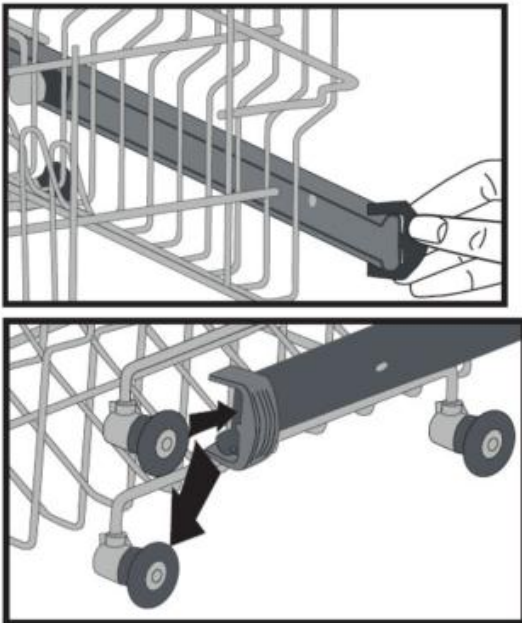

The upper baskets location can be slightly altered as shown in the image to the left.

The benefit of this is by dropping or moving the basket up in the machine you will have more space either below or above for larger items.

In order to change the height, remove the basket by shifting the clip at the end of the rail to the side.

You can then reposition the basket into the machine on the alternate wheels, do not forget to shift the clip at the end of the rail back into position to lock the basket and prevent it from sliding out of the machine.

3.3.2. Alternate Basket Loads

Lower Basket

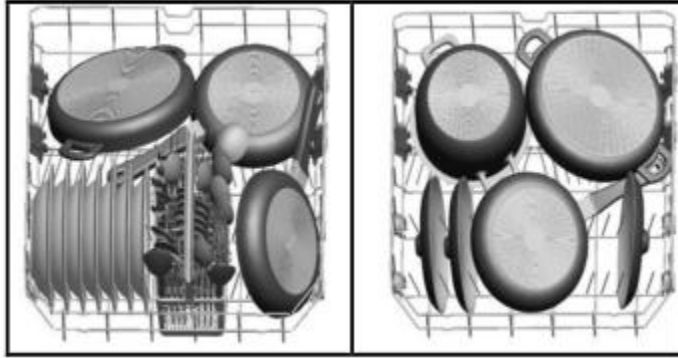

Upper Basket

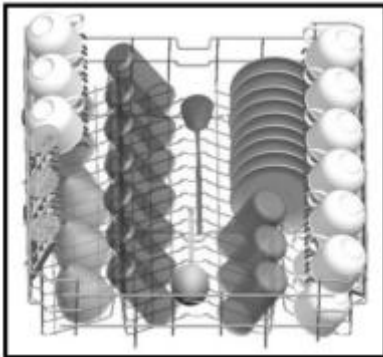

Incorrectly Distributed Loads

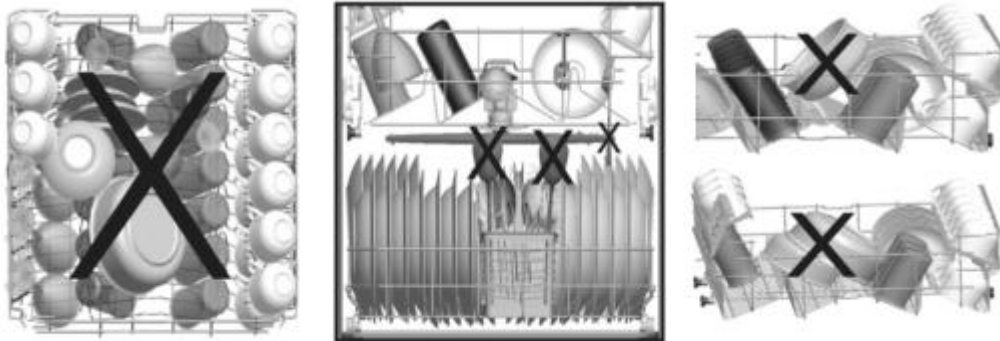

3.4. Programme Selection Table

Programme No			Reference		
Programme names and temp.	Intensive 70°C (P1)	Super 65°C (P2)	Eco 50°C (P3)	Quick 40°C (P4)	Prewash No Heat (P5)
Type of food waste	soups, sauces, pasta, eggs, pilaf, potato and oven dishes, fried food	soups, sauces, pasta, eggs, pilaf, potato and oven dishes, fried food	coffee, milk, tea, cold meats, potato and oven dishes, fried food	coffee, milk, tea, cold meats, vegetables, not kept for long	Prewash to rinse and loosen residue before selecting the required programme.
Level of soil	heavy	medium	medium	light	-
Detergent amount B: 25 cm ³ / 15 cm ³ A: 5 cm	A+B	A+B	A+B	B	-
	Prewash	65°C Wash	Prewash	40°C Wash	Prewash
	70°C Wash	Cold Rinse	50°C Wash	Cold Rinse	End
	Cold Rinse	Hot Rinse	Hot Rinse	Hot Rinse	
	Hot Rinse	End	Dry	End	
	Dry		End		
	End				

Programme duration (min)	187	50	187	30	15
Electricity consum. (kW hours)	1,55	1,35	1,00	0,90	0,02
Water consump. (liters)	16,5	12,7	12,0	12,4	4,5

Warning: Short programs do not include a drying cycle.

The values declared above are the values obtained under laboratory conditions according to relevant standards. These values can change depending on conditions of product's use and environment (water pressure, water input temperature, environment temperature etc).

3.5. Selecting a Programme

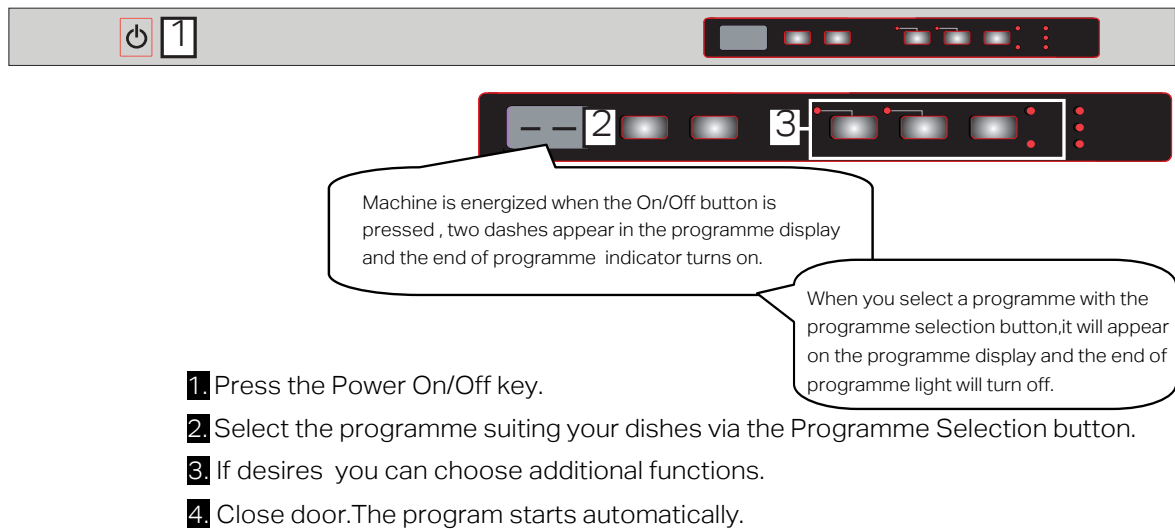

Note: If you decide not to start the machine after selecting the programme, just press the on/off button. Your machine will become ready for the new programme selection when you press on/off button again. You can select the new programme by pressing the programme selection button.

Programme follow-up

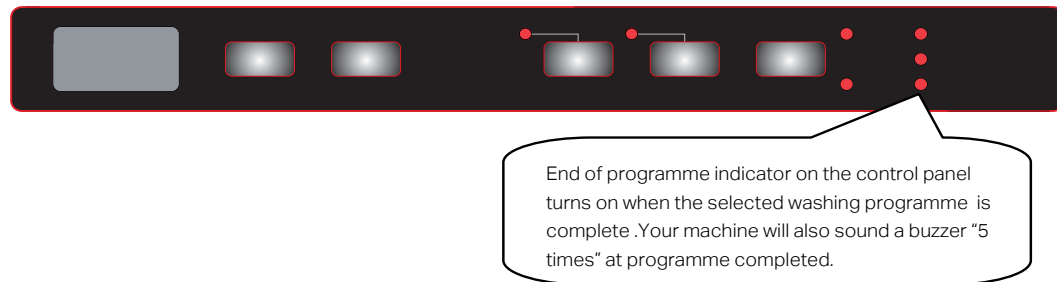

Changing a programme

If you would like to change programmes while a washing programme is running, do the following.

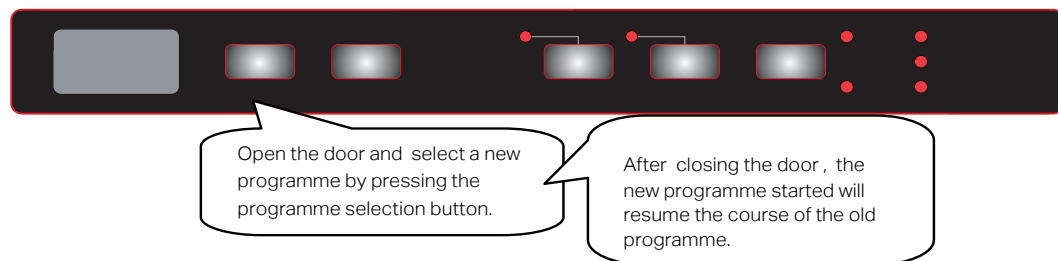

Note: When the door of the machine is opened in order to stop the washing programme before it is completed, first open the door slightly in order to avoid water spillage.

Cancelling a Programme

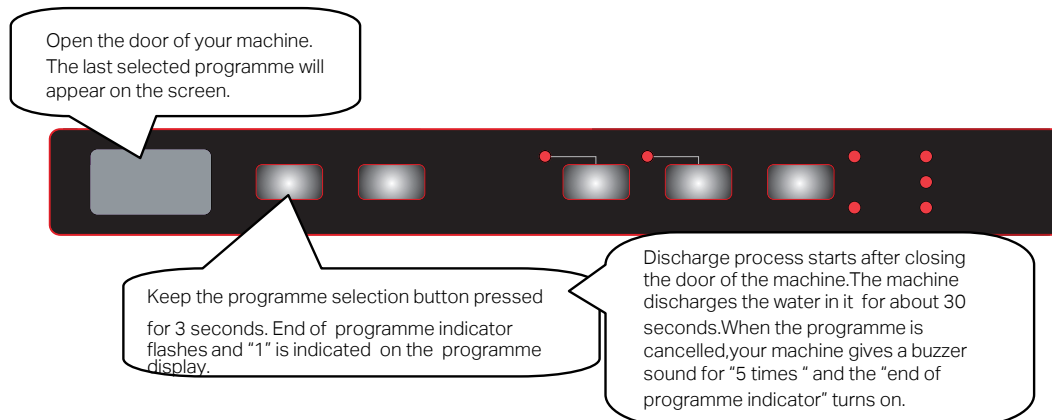

Note: When the door of the machine is opened in order to stop the washing programme before it is finished first open the door slightly in order to avoid water spillage.

Switching the machine off

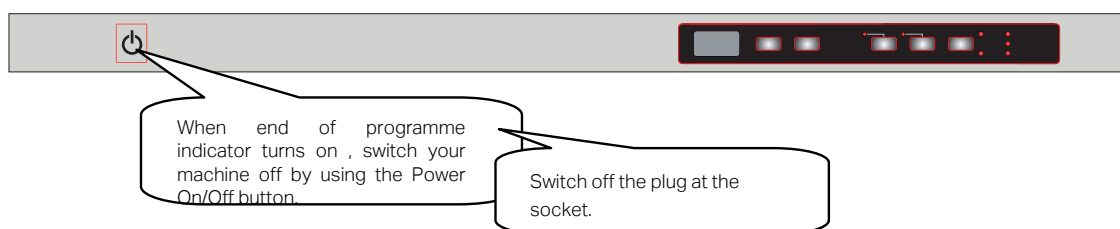

Note: Once your wash programme has finished, leave the dishwasher door slightly ajar to help aid the drying process.

INNER LIGHT OPTION



The door must be at OPEN position during activation and deactivation of inner light modes.

How to change from "ECO MODE" to "NORMAL MODE" for Inner Light option :

- * First open the dishwasher door and energize the machine via main switch (if it is in OFF position).
- * Press "Tablet" and "Prewash" buttons simultaneously for 3 seconds.
- * "IL0" will be shown in the digit display for 2 seconds to show the "Normal Mode" is selected for inner light option.
- * After "Normal Mode" is selected, the inner light will be ON as long as the machine is energized and machine door is open.

How to change from "NORMAL MODE" to "ECO MODE" for Inner Light option :

- * First open the dishwasher door and energize the machine via main switch (if it is in OFF position).
- * Press "Tablet" and "Prewash" buttons simultaneously for 3 seconds.
- * "IL1" will be shown in the digit display for 2 seconds to show the "Eco Mode" is selected for inner light option. Also inner light turns OFF and ON again (blinks momentarily) to show this selection is activated.
- * After "Eco Mode" is selected, the inner light will be ON for 4min after machine door is opened and then turns OFF. If any user intervention occurs such as pressing buttons, Eco Mode cycle starts from beginning (inner light is ON for 4min and then becomes OFF again)

Note: Factory setting for inner light are set to "IL1".

Section 4. Maintenance

4.1. Cleaning the Filter

The filter helps prevent large pieces of food or other items entering the pump and causing damage. It is important that you examine and clean the filter system on a regular basis.

Blocked filters are not covered under the Guarantee!

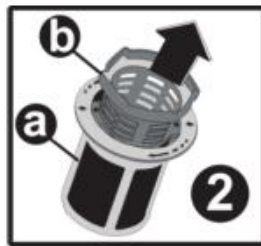
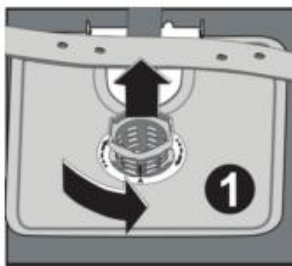

The filter assembly is located inside the appliance just underneath the lower spray arm.

To remove the filter assembly, turn it anti-clockwise and lift the assembly out.

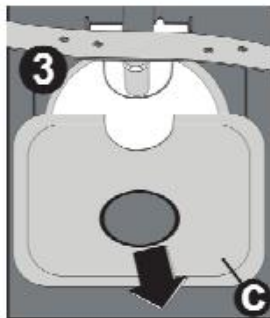

Pull out the metal/plastic filter and then pull the coarse filter out of the micro filter.

Rinse with lots of water under the tap before refitting.

a. Micro Filter b. Coarse Filter c. Metal/Plastic Filter

4.2. Cleaning the Door

Periodically clean the inner stainless steel lining of the door with a warm damp cloth. Pay particular attention to the edges so that food deposits do not build up, causing the door seal to fail. Clean the door seal with warm soapy water.

Never use abrasive cleaners or polishes on the stainless steel!

4.3. Cleaning the Spray Arms

Small particles of food will over time get into the spray arms and cause blockages. Periodically remove the spray arms (as shown below) and wash them in warm soapy water.

Blocked spray arms are not covered under the Guarantee!

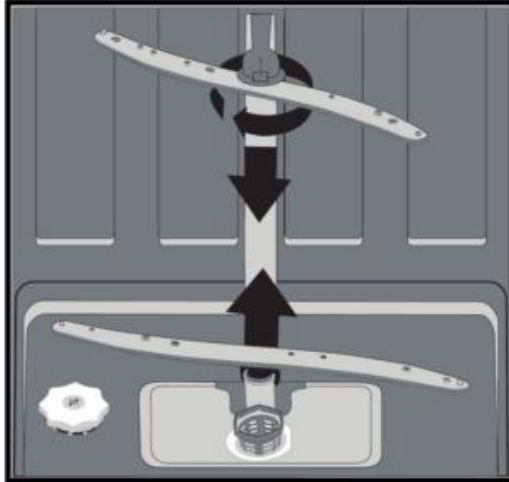

To remove the lower spray arm pull it upwards, so that the upper spray arm nut can be removed by turning the nut to the left.

Be sure that the nut is perfectly tightened when refitting the upper spray arm.

4.4. Daily Maintenance

Follow these useful tips to ensure your dishwasher stays in tip-top working order:

- Always switch off the power supply at the socket when your dishwasher is not in use.
- Always pay particular attention to the filter and spray arms – give them a regular clean as described in 4.1. and 4.3. above.
- Clean the door edges and door seal as described in 4.2. above. Add salt to your appliance when prompted by the salt light on the control panel. Always run a programme after to remove any spilled salt. Add rinse aid to your appliance when prompted by the rinse aid light on the control panel.
- Only use Dishwasher salt, Dishwasher detergent and Dishwasher rinse aid in your dishwasher.
- Never use abrasive cleaners to clean your appliance.
- When the appliance is not in use, leave the door slightly ajar in order to avoid moisture and odours building up inside. **However, this may not be advisable if small children have unsupervised access to the area where the dishwasher is sited.**
- If you are vacating the house for a long period, run a rinse cycle through the machine and then ensure that the water and power supplies to the dishwasher have been turned off. Leave the door ajar.

4.5. Error Codes

Error Code	Error Description	Control
F5	Inadequate water supply	Make sure the water inlet tap is totally open and that there is no water leak Close the water inlet tap, remove the water inlet hose from the tap and clean the filter at the connection end of the hose Restart your machine, contact the Repairtech helpline if the error resumes
F3	Continuous water input	Turn off the tap Contact the Repairtech helpline
F2	The waste water in the machine cannot be discharged	Water discharge hose is clogged The filters of your machine might be clogged Power on/off your machine and activate the program cancel command If the error continues, contact the Repairtech helpline
F8	Heater error	Contact the Repairtech helpline
F1	Alarm is active showing water overflow	Power off your machine and turn off the tap & contact the Montpellier service helpline.
FE	Faulty electronic card	Contact the Montpellier service helpline.
F7	Overheating error	Contact the Montpellier service helpline.
F9	Diverter error	Contact the Montpellier service helpline.
F6	Faulty heater sensor	Contact the Montpellier service helpline.

4.6. Before Calling Service

If you appear to have a problem with your dishwasher, please take a few minutes to check the following 'trouble shooting' guide. The problem may be easily solved without the need for a service call.

Dishwasher Will Not Start

- Is the power on at the socket?
- Is the Start/Pause button set to Pause?
- Have you checked the fuse in the plug?
- Is the dishwasher door closed correctly?
- Is your water pressure low – if yes, wait until normal pressure is resumed

Water Left In Bottom of Dishwasher

- Check & clean the filter
- Make sure the drain hose is not trapped/kinked

Soap Suds in the Dishwasher

- Are you using the correct dishwasher detergent/tablets. You must only use specialist dishwasher detergent in a dishwasher
- You may have spilled rinse aid into the dishwasher whilst topping up the dispenser – it will clear after one or two rinse or wash programmes.

There Are Rust Stains on the cutlery

- Your utensils may not be dishwasher safe – you must use dishwasher safe utensils
- You may have spilled salt into the dishwasher whilst topping up the salt dispenser and not run a programme to flush it away (see 3.1.1 - Page 9)

Knocking Noise From Inside the Cabinet

- The spray arm is catching against an item in the basket – reposition the items
- Items of crockery are loose in the basket and water pressure is causing them to move – reposition the items of crockery

The Crockery is not Clean

- Ensure that you load items correctly – do not stack items on top of other items
- You selected the wrong wash programme – select a stronger wash
- Did you use enough detergent?
- Have you cleaned the spray arms recently?
- Have you cleaned the filters recently?

The Glasses are Cloudy

- Are your glasses dishwasher safe? You must only place dishwasher safe glassware in a dishwasher
- Soft water can leave cloudy marks on glassware
- Too much detergent can cause cloudy marks on glassware

The Crockery is not Drying

- Ensure you load the baskets with space around the items
- Check your rinse aid – top up the dispenser
- Do not unload your dishwasher too soon - allow the drying process time to work

Warning!

If your dishwasher overflows or develops a water leak, you must turn off both the water and power supplies until an engineer has corrected the fault.

Technical Spec

Capacity	12 Place Settings
Height	820mm – 870mm
Width	598mm
Depth	550mm
Net Weight	38kg
Electricity Input	220-240 V, 50Hz
Total Power	1900W
Heating Power	1800W
Pump Power	100W
Drain Pump Power	30W
Water Supply Pressure	0.03 Mpa (0,3 bar) – 1 Mpa (10 bar)
Current	10 A

Here For You

After-sales assistance

If you continue to experience problems with your Integrated Dishwasher, please call the Montpellier customer service helpline on: **01759 487839**.

Please have all your product details available, including the model number, serial number, date of purchase, and your retailer's details before registering a fault.

The service call cannot progress without this information.

Your 2 year Manufacturer's guarantee

THIS DOES NOT AFFECT YOUR STATUTORY RIGHTS.

Your new Montpellier appliance carries a free guarantee which protects you against the cost of repairs during the first 24 months from date of purchase provided that:

Any claim is accompanied by evidence of the model reference, model serial number and proof of purchase, such as a Sales Receipt, showing that the appliance was purchased within the 24 months prior to the date of claim.

What is not covered under the Guarantee

- Any appliance not correctly installed and operated in accordance with the manufacturer's instructions.
- Any appliance that is used for anything other than domestic purposes.
- Any defect caused by accident, misuse, unauthorised modification or inexperienced repair.
- Cost of Call-out where a fault cannot be found with the appliance.
- Cost of Call-out for work covering routine maintenance, such as, but not exclusively, cleaning of filters or defrosting.
- Cost of Call-out for work required to correct the alignment of doors following door reversal procedures carried out by you.
- Use of the appliance by anyone other than the Householder.
- Use in any commercial environment.
- Consumable items, such as, but not exclusively, fuses in plugs, bulbs and breakable items which require routine replacement.
- Repair costs incurred that have not been authorised by Repairtech and/or carried out by a non-approved Repairtech engineer.

YOUR GUARANTEE IS VALID ONLY IN THE UK & ROI.

To register your appliance simply complete the card in your appliance pack and return it with a stamp affixed or alternatively you can register online at **www.montpellier-appliances.com/support**

SERVICE HELP-LINE

Should your appliance develop a fault, please call the Montpellier customer service helpline on: **01759 487839**.

Please remember to have all your product details available, including the model number, serial number, date of purchase and your retailer's details before registering a fault.

Your service call cannot progress without this information.

Montpellier Domestic Appliances Ltd.

Unit 1, Tewkesbury Retail Park, Northway Lane,
Tewkesbury, Gloucestershire GL20 8JU

www.montpellier-appliances.com



The symbol on the product or on its packaging indicates that this product may not be treated as household waste. Instead it shall be handed over to the applicable collection point for the recycling of electrical and electronic equipment. By ensuring this product is disposed of correctly, you will help prevent potential negative consequences for the environment and human health, which could otherwise be caused by inappropriate waste handling of this product. For more detailed information about recycling of this product, please contact your local city office, your household waste disposal service or the shop where you purchased the product.